

SL TECHNIC

SELF DESTRUCTION MECHANISM

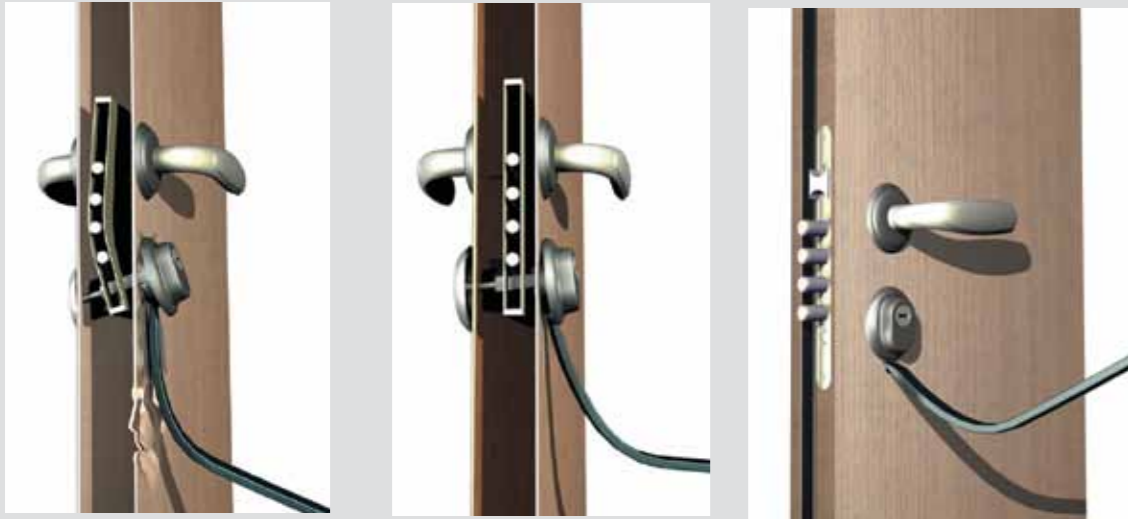

SUPERLOCK has developed a unique self-destructing mechanism that makes it difficult to break into the entrance door. Any attempt to harm the exterior cylinder shield or the cylinder itself triggers a chain reaction by which the lock is damaged. As a result, the locking system sticks, creating a situation in which it is stuck fast (like with a safe). The self-destructing mechanism is installed on all the entrance doors produced in our plant

SECURITY LOCK



Luxury Rim Lock



Extra Lock (exterior side)



Extra Lock (interior side)

SL TECHNIC SCANNING DOOR

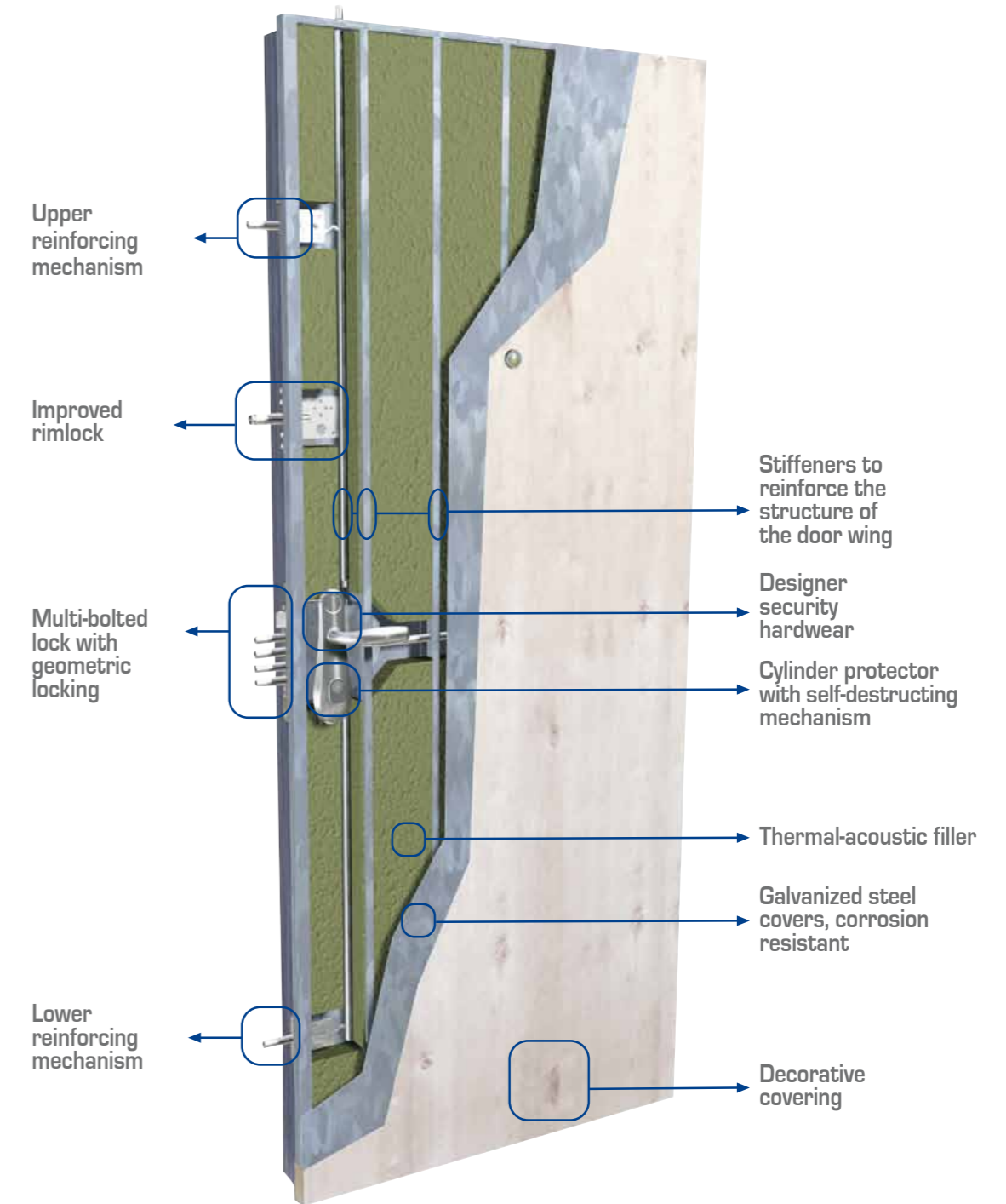

SL TECHNIC

Specification:

- Geometrical Lock (applying force on the bolt does not affect the other bolts)
- Locking/unlocking operation is achieved by one turn of key
- Bolt projection: 25mm
- Corrosion resistance: 8hr salt for test
- 4 front bolts with 14mm diameter for lock 125
- 4 front bolts with 10mm diameter for lock 124
- 3 additional bolts to other direction 14mm diameter each
- Axial load on bolt up to 500kg per EN 12209
- Lateral load on bolts up to 700kg per EN 12209

Security lock model 125 - drawing

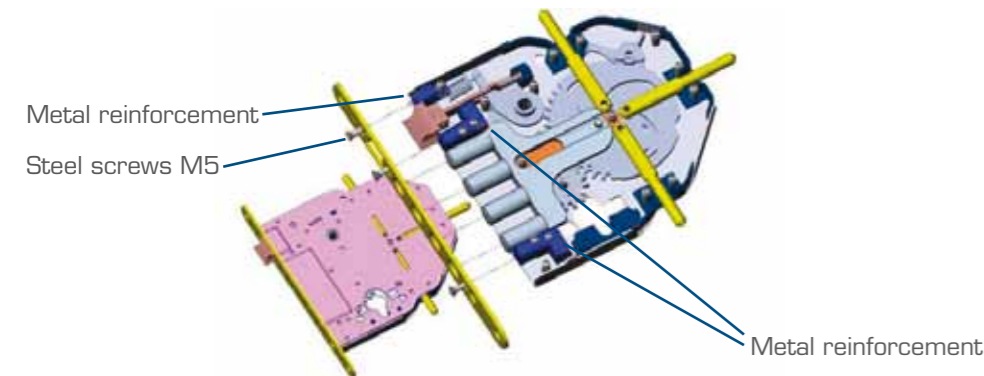

Security lock model 124

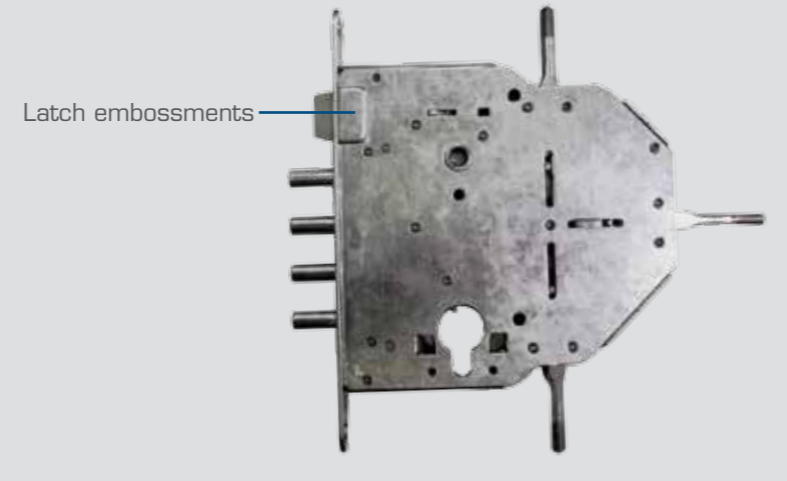

Security lock model 125

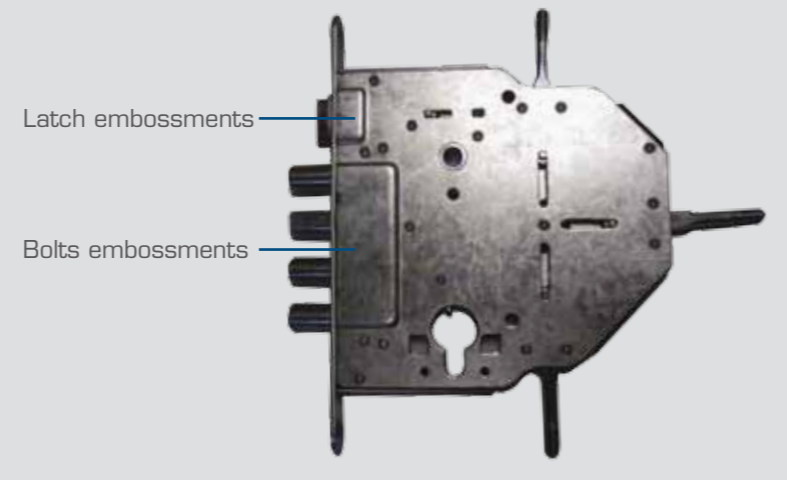



IMP
Rok zał. 1927

INSTYTUT MECHANIKI PRECYZYJNEJ
Zakład Certyfikacji
01-796 Warszawa, ul. Duchnicka 3
tel. 0-22 663-43-14, 0-22 560-25-40
e-mail: wojtan@imp.edu.pl
http://www.imp.edu.pl/cert



PCA
Polski Centrum
Akredytacji
AC 041

CERTIFICATE OF CONFORMITY

No. P41/325/2008 (3037)
ENGLISH EDITION

Name and address of the certificate owner:	SHIRYONIT HOSEM SECURITY PRODUCTS MANUFACTURING (1991) LTD. 12 DERECH HAHAROSHET, NEW IND. ZONE, KIRYAT GAT, ISRAEL
Name and address of the manufacturer:	SHIRYONIT HOSEM SECURITY PRODUCTS MANUFACTURING (1991) LTD. 12 DERECH HAHAROSHET, NEW IND. ZONE, KIRYAT GAT, ISRAEL
Product name:	Door lock
Type (variants):	LOCK 125
Main features:	Class of protection: - 4 - acc. to PN-EN 12209: 2005 Detailed classification on the reverse
SWW and PKWIU symbols:	PKWIU 28.63.12-30.00
The product is in accordance with:	PN-EN 12209: 2005
According to the report issued by:	Search Laboratory for Mechanical Security Products of Institute of Precision Mechanics (Cert. of Accr. AB035)
No. and date of the report:	No. LB-1/110/2007 issued on March 1, 2007
Date of expiration:	September 11, 2011

Rights for using this certificate from September 12, 2008 until September 11, 2011 refer only to products having identical parameters as sample(s) shown for inspection and meeting requirements stated in application No. 176/W/2008.
Certification of conformity acc. to the model type evaluation, testing & evaluation of samples, supervision including inspection of supplier's quality system.

MANAGER
Certification Division



Wojciech DĄBROWSKI, M.A.E.



DIRECTOR
Institute of Precision Mechanics



prof. Aleksander NARONIECZNY, D.Eng.

Certificate can be published only by Certificate Owner without comments, abbreviations and changes.
Warsaw, September 12, 2008.

INSTYTUT MECHANIKI PRECYZYJNEJ

Formularz F-2.2, edycja I, 19-02-2007 r.

No. P41/325/2008 (3037)

1	2	3	4	5	6	7	8	9	10	11
Category of use	Durability and load on latch bolt	Door mass and closing force	Suitability for use on fireproof doors	Safety	Corrosion resistance and temperature	Security and anti-resistance	Field of door application	Type of key operation and locking	Type of spindle operation	Key identification
2	A	2	1	0	0	4	B	A	2	0

KIERCOWNIK
ZAKŁADU Certyfikacji



mgr inż. Wojciech Dąbrowski

INSTYTUT MECHANIKI PRECYZYJNEJ

Formularz F-2.2, edycja I, 19-02-2007 r.

SL TECHNIC FRAME INSTALLATION METHODS

CONSTRUCTION FRAME



Installation of security door of construction frame with cement filling.

BASIC FRAME

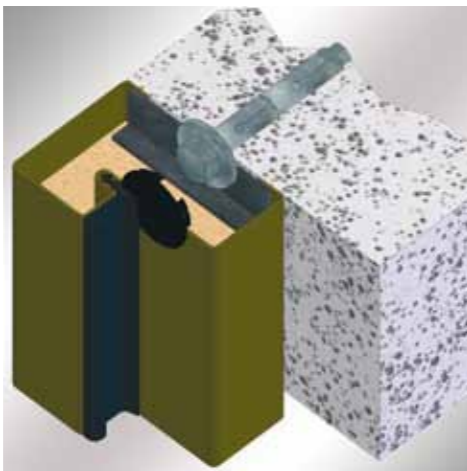

Installation of security door on basic frame with heavy duty anchors and polyuretahne insulation.

EMBRACING FRAME

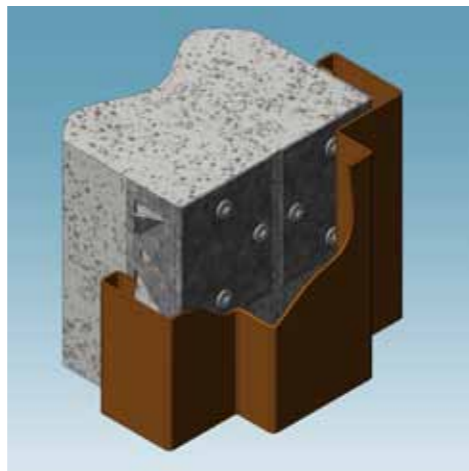

Installation of security door on embracing frame (usually gypsum wall)

ADJUSTABLE FRAME

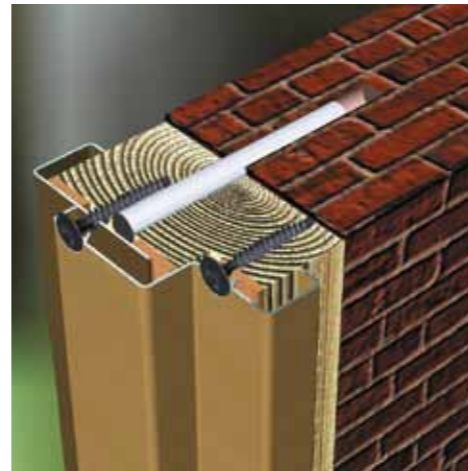

Installation of security door on adjustable frame with existing wood frame base.

SL TECHNIC FRAMES SWATCHES

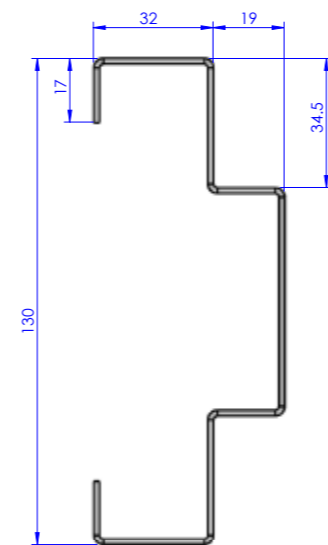

Construction Frame

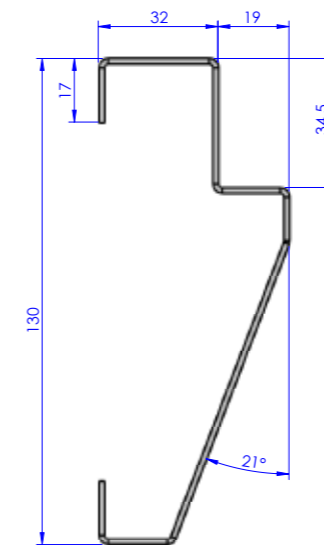

Sloping Construction Frame

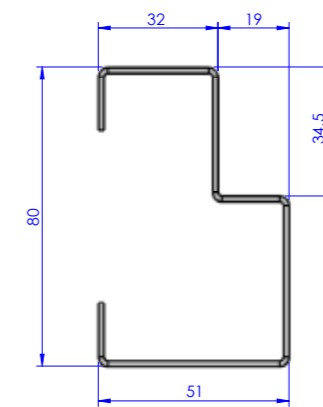

Asymmetric Basic Frame

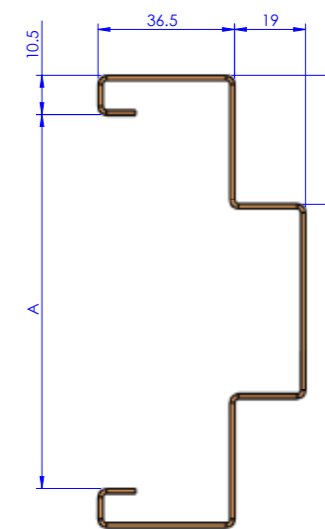

Embracing (Slip-on) Frame

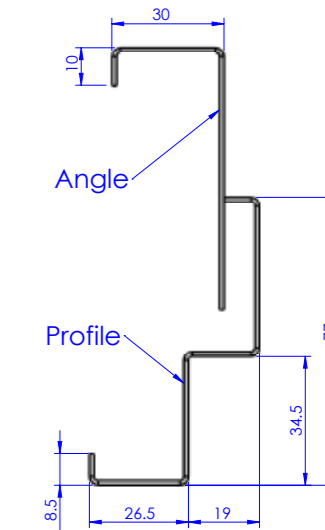

Adjustable Frame

WALL OPENING - CONSTRUCTION FRAME

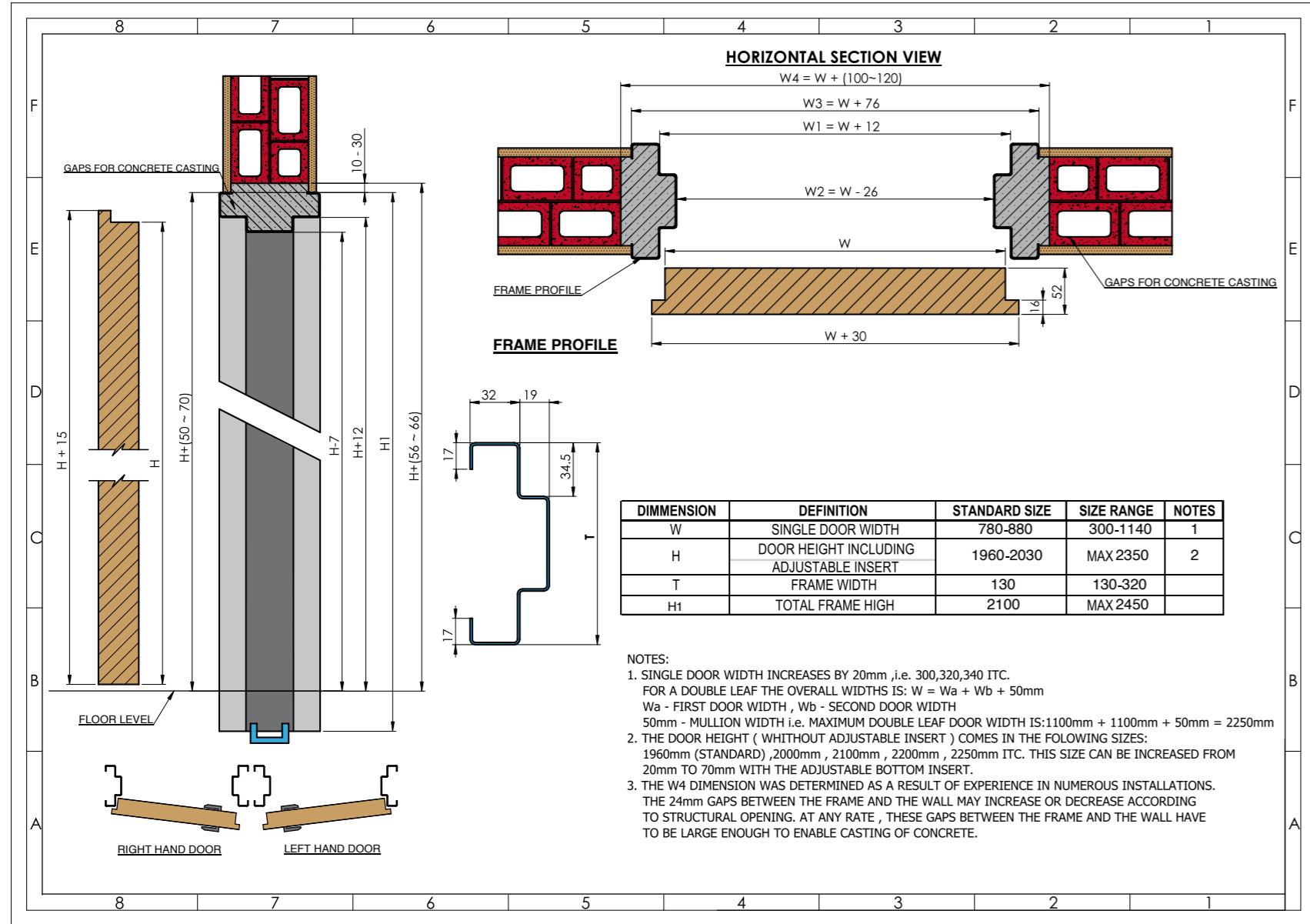

WALL OPENING - BASIC CONNECTED FRAME

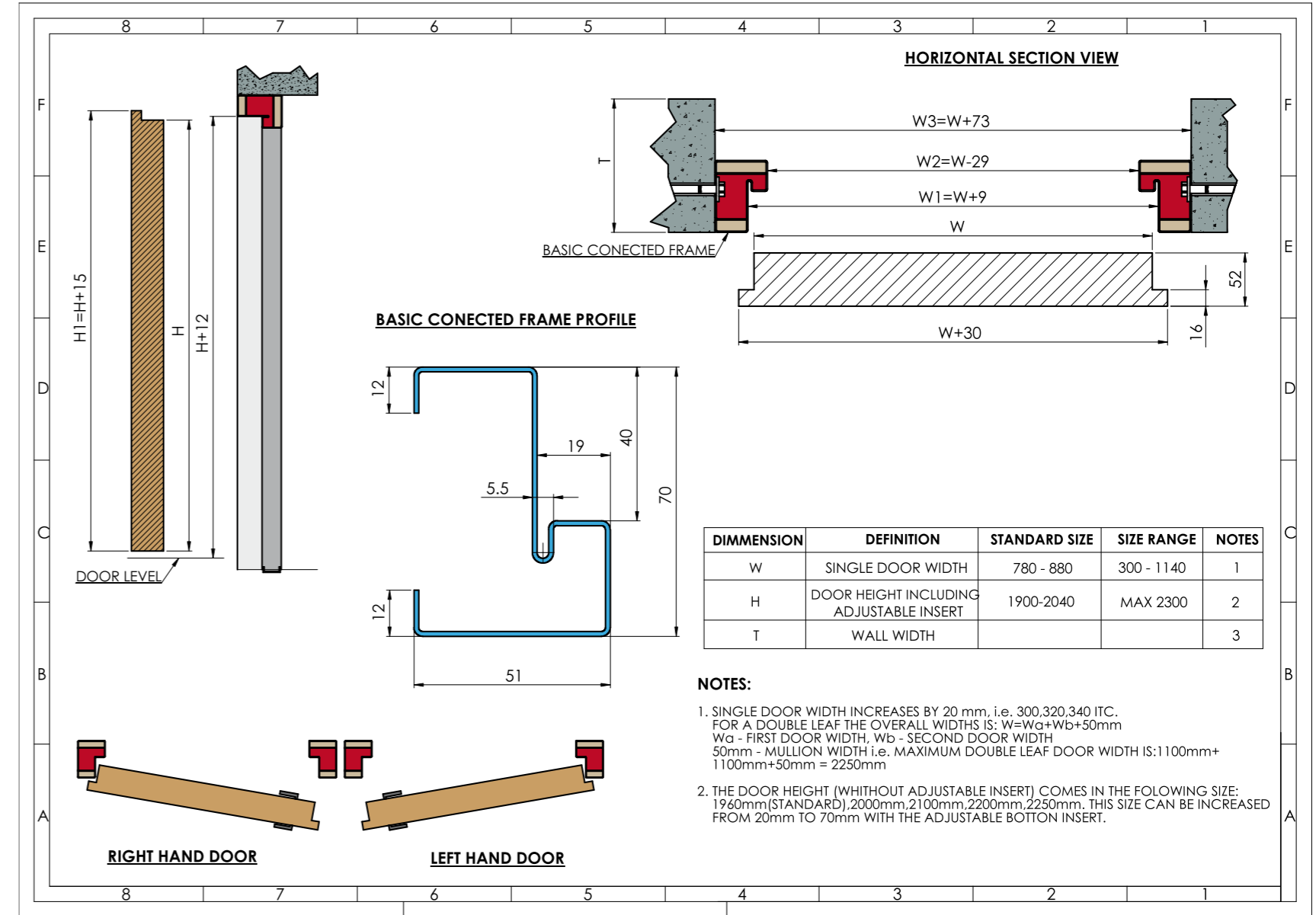

WALL OPENING - EMBRACING FRAME

